

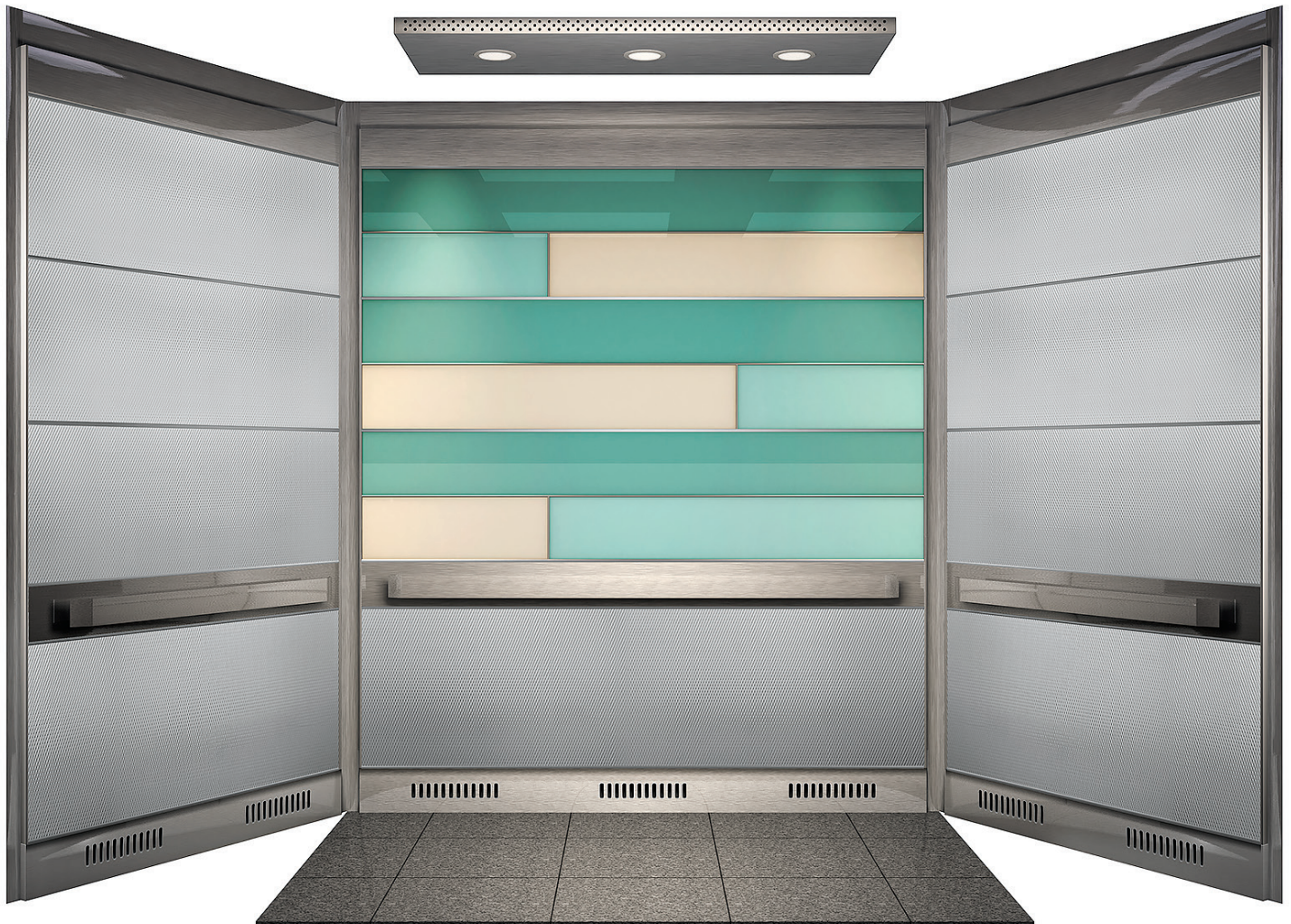

# HANDRAILS

## INSTALLATION INSTRUCTIONS



## SECTION 1: UNPACKING

- 1.1. Carefully un-crate the handrail components, making sure that none of the components are damaged.
- 1.2. Check the colours, features, and dimensions of the components against your order before you begin installing the handrail finishes.
- 1.3. If you have ordered a full cab, the mounting holes for the handrails or bumper rails will be pre-drilled into the panels.

For technical support on the handrail installation, please contact us at:

**Elevator Cab Renovations**  
Office: (613) 745-4870  
Toll Free: 1-877-745-4870  
ecr@elevatorcabs.ca

Office Hours : 6:30 AM to 3:30 PM Eastern Standard Time

## SECTION 2: INSTALL HANDRAILS

- 2.1. Begin by first determining the height to the top of the bumper rail based off site conditions. this dimension will be given on the shop drawings (if applicable).



**Note: If no value is given, the top of the handrail must sit between 800mm {31.5"} to 920mm {36.2"} above the finished floor (per ASME A17.1 - CSA B44).**

- 2.2. Handrails are generally centered on their corresponding wall; measure and mark the location of each standoff.



**Note: Before drilling, hold the handrail in position to ensure the standoffs are properly marked. Verify there are no obstructions attached to the shell before drilling.**

## SECTION 2: INSTALL HANDRAILS (CONTINUED)

- 2.3. Drill 1/2" holes into the cab shell as marked on the previous step.
- 2.4. Insert and secure the provided togglers through the finishes and the shell (see notes below 'Installing the Toggles').
- 2.5. Place the flared end of a stainless steel standoff against the handrail panel, centered on the toggler. Fasten this to the wall and handrail panel with the 1/4"-20 bolts provided.
- 2.6. Slide the inserts into the standoff (inserts are attached to the handrail).
- 2.7. Secure the handrail to the standoff using the set screws provided (Dia. 1).

### Installing the Toggles

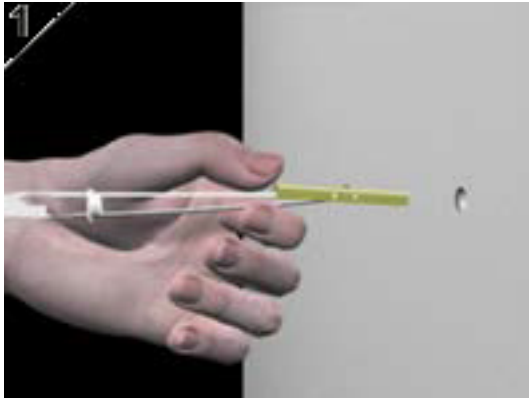

Drill a 1/2" hole. Hold the metal channel flat alongside plastic straps and slide channel through the metal channel through the hole. The minimum clearance behind the wall is 1 7/8".

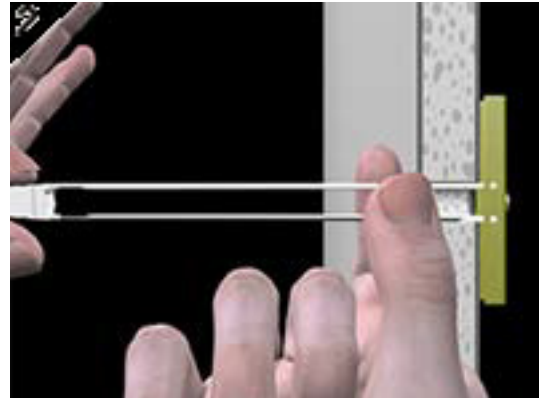

Hold the ends of straps between thumb and forefinger and pull toward you until channel rests flush behind wall. Slide plastic cap along straps with other hand until flange of cap is flush with the wall.

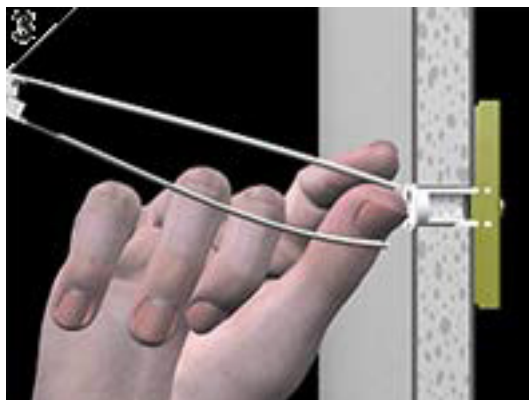

Snap straps at wall by pushing side to side snapping off straps level with flange cap.

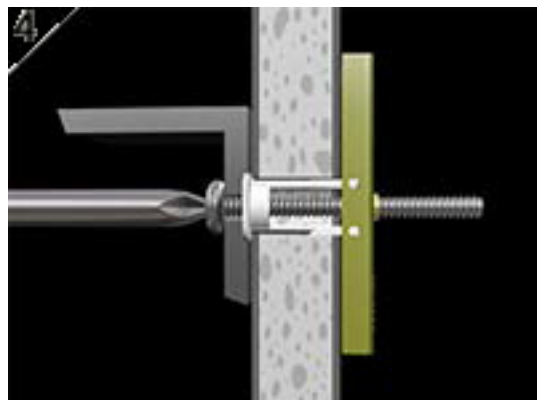

Place item over flange. Insert bolt through item and tighten until flush against item.

## SECTION 2: INSTALL HANDRAILS (CONTINUED)

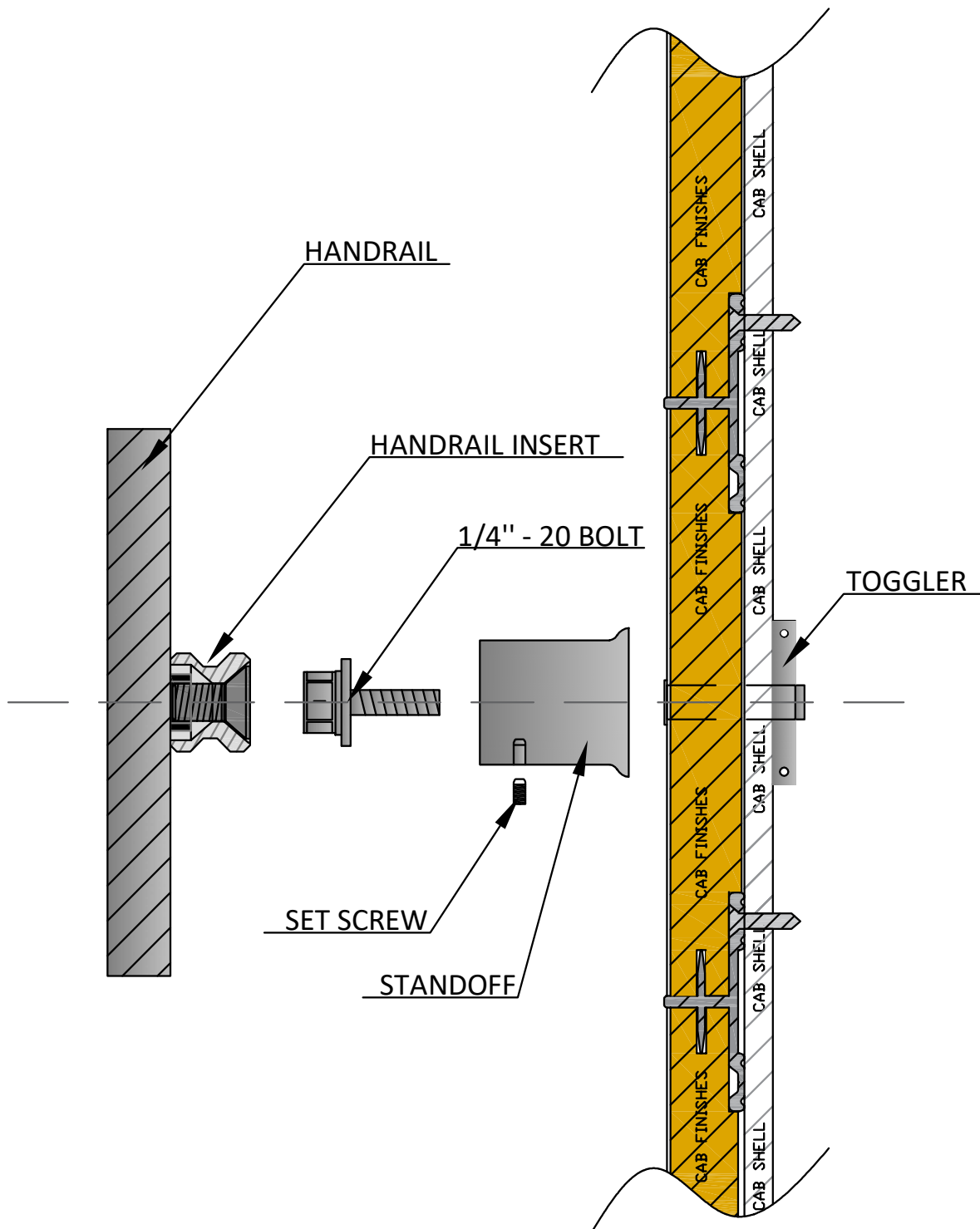

**Dia. 1**  
Attaching standoffs to handrail.