

FIXTURES

PRODUCT CATALOG

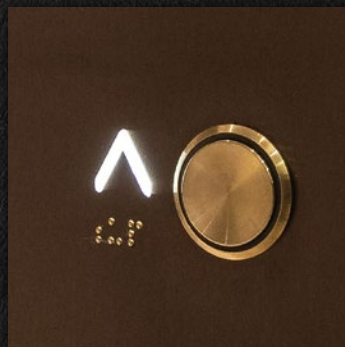
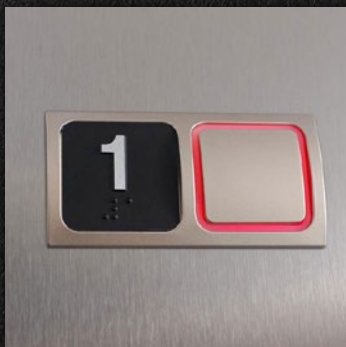
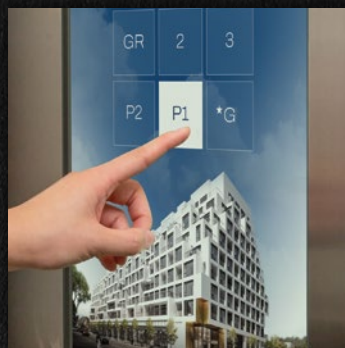
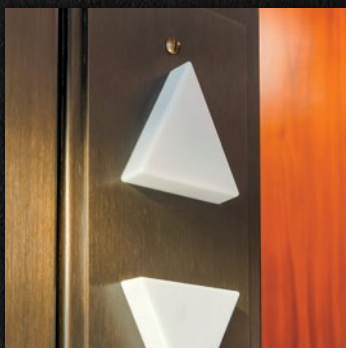

TABLE OF CONTENTS

4	Car Operating Panels	24	Hall Fixtures
6	Swing Panel	26	Hall Stations
7	Applied Panel	28	Hall Lanterns
8	Gilda Panel	30	Destination Dispatch
9	Dover + Impulse Panel	31	Destination Lanterns
10	Glass Panel		
11	Custom Panel	32	Displays
12	Push Buttons	34	Position Indicators
14	BL Blank	35	Altus (Large Format PI)
15	BS Classic	36	Touch-To-Go Touchscreens
16	BS Moon	38	Germ-Free Solutions
17	BS California	40	Sherman Touchless
18	Atoll	41	Contactless Access™
19	BP Classic	42	Toe-To-Go
20	Dune / Dune California	42	BS Copper
21	Colossus		
22	Sherman Touchless		
23	Bar Button		
23	Push Button Configurator		



CAR OPERATING PANELS

Our Car Operating Panels combine durability, code compliance, and customizable design to elevate the passenger experience. Engineered for both new construction and modernization, our panels are available in a wide range of finishes, layouts, and configurations to suit any building style or spec. Built to last and designed to impress.



SCAN HERE
To learn more!





SWING PANEL

Engineered for precision fit and service efficiency, Swing Panels provide full access to large backbox for COP components with secure latching and robust hinges. Designed for seamless integration into cab interiors, they are available in a full range of code compliant configurations and finishes.



APPLIED PANEL

Applied Panels deliver a durable, surface-mounted COP solution for modernization or new construction. Offered in customizable layouts, finishes, and button configurations, they meet all applicable code requirements while streamlining installation.



Swing panel shown with:
SS#4 Finish, 7" Giotto Position Indicator, Auto Dialer, Fire Service Cabinet, Vanishing Indicator, BS Classic Pushbutton with Julius Surround tactile, Card Reader, E-Light.



Swing panel shown with:
Brushed Brass (60/40 Muntz) Finish, 7" Giotto Position Indicator, Auto Dialer, Fire Service Cabinet, Vanishing Indicator, Atoll Pushbutton with California Fishtail tactile, Card Reader, E-Light.



Swing panel shown with:
Oil Rubbed Finish, 10" Matisse Position Indicator with Elev8, Auto Dialer, Fire Service Cabinet, Vanishing Indicator, BP Classic Pushbutton with Pin Mount tactile, Card Reader, E-Light.



Applied panel shown with:
SS#4 Finish, 10" Matisse with MosaicONE Digital Signage, Auto Dialer, Fire Service Cabinet, Vanishing Indicator, Keyswitches, Colossus Pushbutton with Slimline tactile, E-Light.



Applied panel shown with:
Brushed Brass (60/40 Muntz) Finish, 7" Giotto Position Indicator, Auto Dialer, Fire Service Cabinet, Vanishing Indicator, BS Moon Pushbutton with Caesar White Illuminated tactile, Card Reader, E-Light.



Applied panel shown with:
Black Powder coat Finish, 7" Giotto Position Indicator, Auto Dialer, Fire Service Cabinet, Vanishing Indicator, BP Classic Pushbutton with Pin Mount tactile, Card Reader, E-Light.



GILDA PANEL

The Gilda surface-mount COP offers a low-profile, 15/16" depth design for rapid modernization without modifying the existing opening. Fully customizable and code-compliant, it provides a clean, efficient upgrade path for existing installations.



DOVER PANEL

A direct-fit replacement for Dover Impulse fixtures, the Impulse+ Retrofit Kit eliminates cutting and measuring for faster installation and minimal downtime. Built for durability, it delivers a modernized appearance with straightforward field replacement.



Gilda panel shown with:
SS#4 Finish, ECS Camera, 7" Matisse Position Indicator, Auto Dialer, Fire Service Cabinet, Vanishing Indicator, Dune pushbutton with surround tactile, Card Reader, E-Light.

Gilda panel shown with:
Brushed Brass (60/40 Muntz) Finish, 10" Matisse Position Indicator with Elev8, Auto Dialer, Fire Service Cabinet, Vanishing Indicator, BS Classic Pushbutton with Round tactile, Card Reader, E-Light.

Gilded panel shown with:
Oil Rubbed Finish, 7" Giotto Position Indicator, Auto Dialer, Fire Service Cabinet, Vanishing Indicator, Atoll Pushbutton with California Fishtail tactile, Card Reader, E-Light.

Dover panel shown with:
SS#4 Finish, 7" Giotto Position Indicator, Auto Dialer, Fire Service Cabinet, Vanishing Indicator, Sherman Touchless Pushbutton with Square tactile, Card Reader, E-Light.

Dover panel shown with:
Brushed Brass (60/40 Muntz) Finish, 7" Giotto Position Indicator, Auto Dialer, Fire Service Cabinet, Vanishing Indicator, BS Classic Pushbutton with Julius Surround tactile, Card Reader, E-Light.

Dover panel shown with:
Oil Rubbed Finish, 7" Giotto Position Indicator, Auto Dialer, Fire Service Cabinet, Vanishing Indicator, BP Classic Pushbutton with Slimline tactile, Card Reader, E-Light.



GLASS PANEL

Glass COPs offer a sleek, modern alternative to traditional stainless steel fixtures, bringing architectural design into the forefront of the elevator cab. Ideal for contemporary interiors, they combine clean lines with full functionality and can be customized to match the aesthetic of any space.



CONCEPT PANEL

Custom COPs provide the freedom to match any design vision, with options for unique finishes, layouts, and materials. From subtle accents to bold statements, they combine creativity with functionality and code compliance.

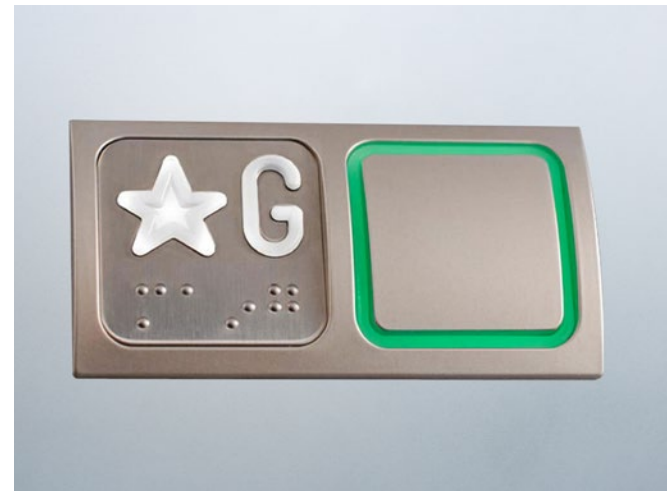

Back-Painted Glass



Decorative Glass

Additional glass options available

Glass panel shown with:

Custom back-painted code compliant glass, 7" Giotto Position Indicator, Auto Dialer, Fire Service Cabinet, Vanishing Indicator, Dune pushbutton with surround tactile, Card Reader, E-Light.

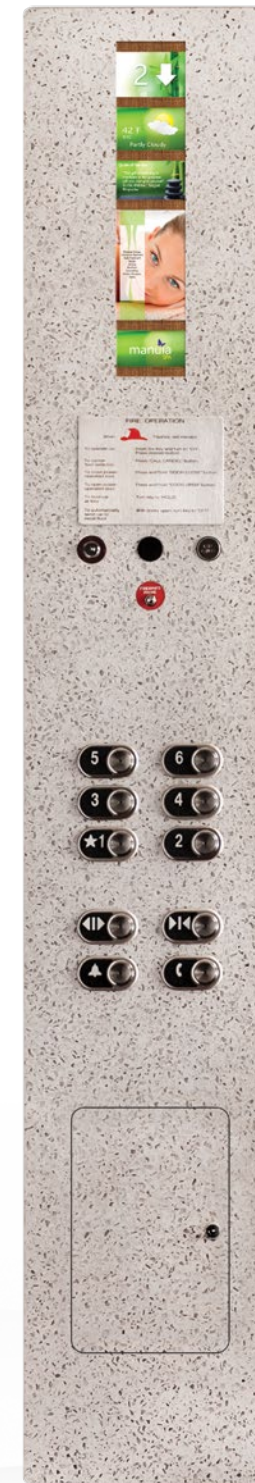

If you can envision it, we can build it.

Our team of engineers and designers are always looking for a new challenge. Making a custom design and materializing the idea is what defines who we are.

Concept panel shown with:

Agglomerated Marble finish, 19" custom panoramic Position Indicator, Fire Service, BS Moon with Julius Surround tactile, 2000 code.



PUSHBUTTONS

We offer a full range of pushbuttons engineered for durability, performance, and design flexibility. From sleek modern styles to vandal-resistant options, our buttons are built to meet code requirements while enhancing the look and feel of any elevator interior. Available in a variety of finishes, tactile options, and illumination styles to suit both new construction and modernization projects.



SCAN HERE
To learn more!





BL BLANK

The BL Blank is a premium vandal-resistant pushbutton designed for durability and aesthetic appeal. It is crafted from turned stainless steel to withstand water, dust, and impact damage, ensuring an average lifespan of 1.5 million activations. It is distinguished by its smooth, flat surface and minimalist design, offering a sleek, modern look.

Illumination

Button Finish Available in #4 Stainless Steel

Tactile Pairings



Square - Surface Mount

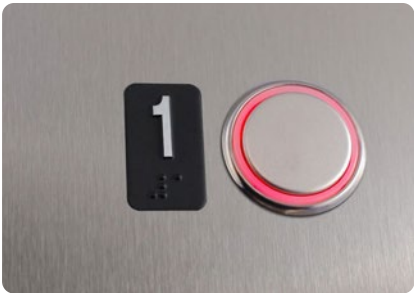

Slimline - Flush Mount



Square - Flush Mount



Round - Flush Mount



Julius - Flush Mount



California Fishtail

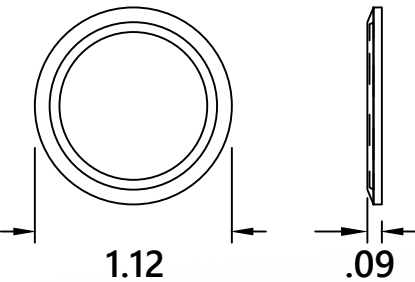

BS CLASSIC

The BS Classic is a premium vandal-resistant pushbutton designed for durability and aesthetic appeal. Crafted from turned stainless steel, it resists water, dust, and impact damage, ensuring an average lifespan of 1.5 million activations. It features a round domed surface and illuminated halo, offering a timeless and functional design.

Illumination

Button Finish Available in #4 Stainless Steel & PVD Brass

Tactile Pairings



Square - Surface Mount



Julius Surround



Pin Mount



Caesar Non Illuminated



Caesar White Illuminated



Caesar Blue Illuminated



Slimline - Flush Mount



Square - Flush Mount



Round - Flush Mount



Julius - Flush Mount



California Fishtail

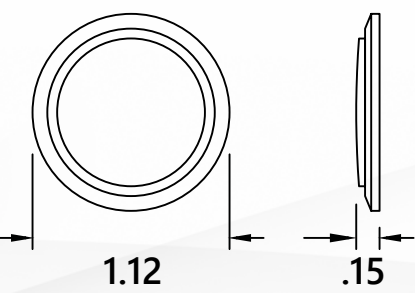



BS MOON

With its distinctive convex shape and smooth edges, the BS Moon pushbutton offers a refined look with comfortable tactile response. Designed for durability and available with optional halo illumination, it's a stylish yet practical choice for modern elevator interiors.

Illumination 
Button Finish Available in #4 Stainless Steel & PVD Brass

Tactile Pairings

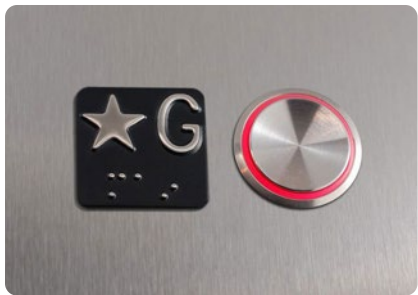

Square - Surface Mount



Julius Surround

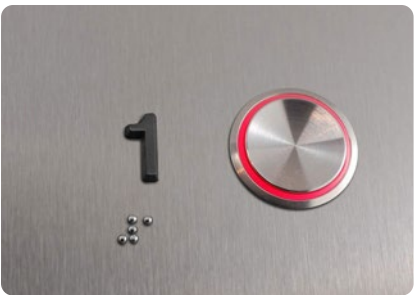

Pin Mount



Caesar Non Illuminated



Caesar White Illuminated



Caesar Blue Illuminated

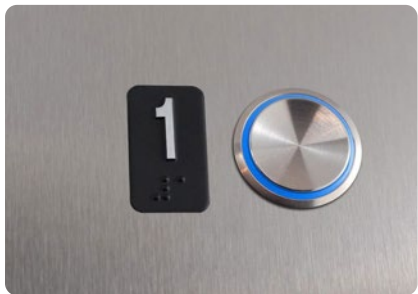

Slimline - Flush Mount

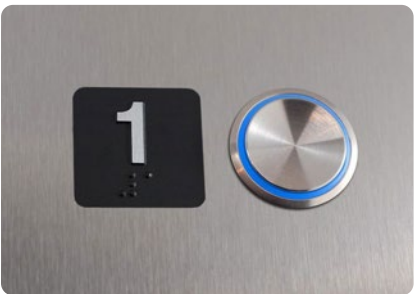

Square - Flush Mount

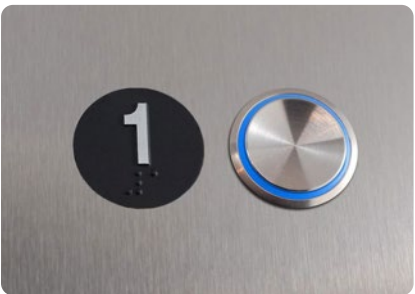

Round - Flush Mount



Julius - Flush Mount



California Fishtail

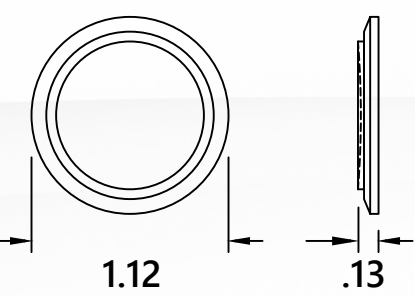

1.12 .13



BS CALIFORNIA

Engineered to meet California accessibility requirements, the BS California pushbutton features a raise face to meet code. Its durable design and optional halo illumination make it a compliant and stylish solution for any project.

Illumination 
Button Finish Available in #4 Stainless Steel & PVD Brass

Tactile Pairings

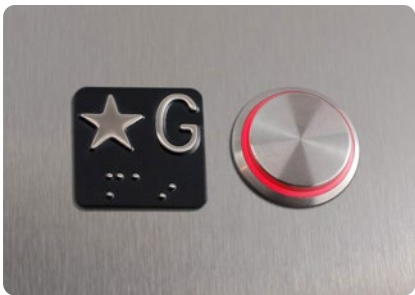

Square - Surface Mount



Julius Surround



Pin Mount



Caesar Non Illuminated



Caesar White Illuminated



Caesar Blue Illuminated

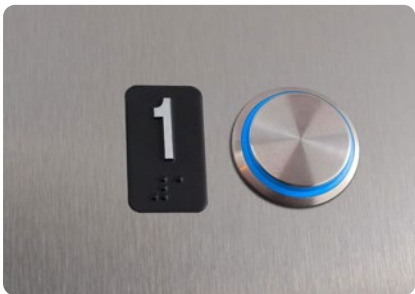

Slimline - Flush Mount

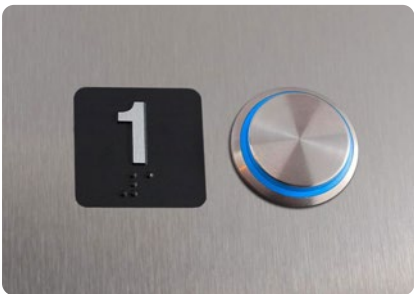

Square - Flush Mount

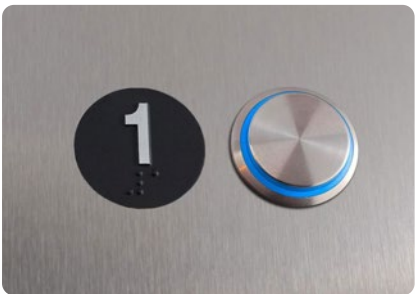

Round - Flush Mount



Julius - Flush Mount



California Fishtail

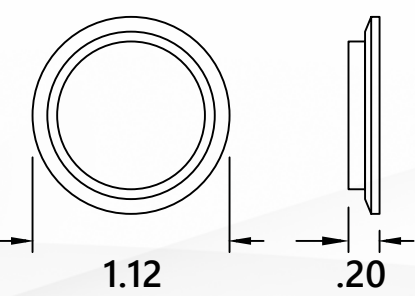

1.12 .20



ATOLL

The fully California Compliant Atoll button is the intersection between design and compliance. The full illumination in white of the button and 1/8th protrusion—the Atoll pushbutton delivers a clean aesthetic without sacrificing visibility. Ideal for contemporary interiors and retrofit projects alike.

Illumination 

Button Finish Available in #4 Stainless Steel & PVD Brass

Tactile Pairings

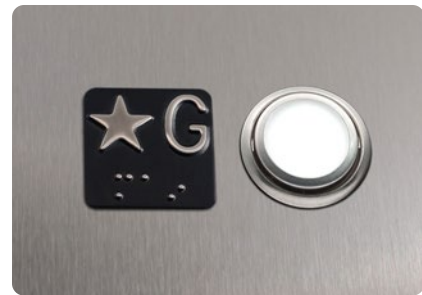

Square - Surface Mount



Julius Surround



Pin Mount



Caesar Non Illuminated



Caesar White Illuminated



Caesar Blue Illuminated

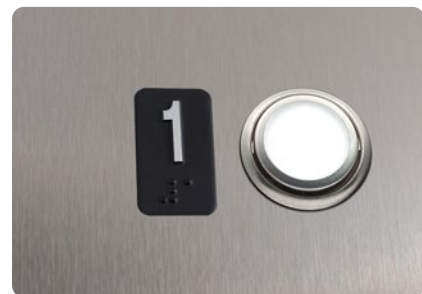

Slimline - Flush Mount



Square - Flush Mount



Round - Flush Mount



Julius - Flush Mount



California Fishtail

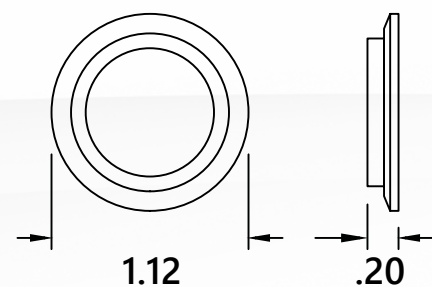

BP CLASSIC

Timeless and dependable, the BP Classic pushbutton features a traditional round design with tactile feedback and optional halo illumination. Built for longevity and ease of use, it's a trusted choice for a wide range of elevator applications—combining familiarity with MAD's proven durability.

Illumination     

Button Finish Available in #4 Stainless Steel & PVD Brass

Tactile Pairings



Square - Surface Mount



Julius Surround



Pin Mount



Caesar Non Illuminated



Caesar White Illuminated



Caesar Blue Illuminated

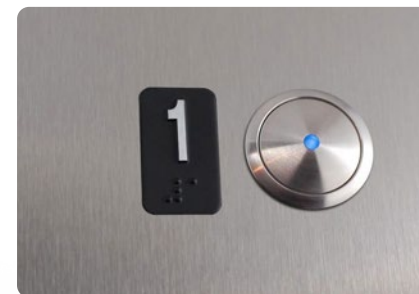

Slimline - Flush Mount

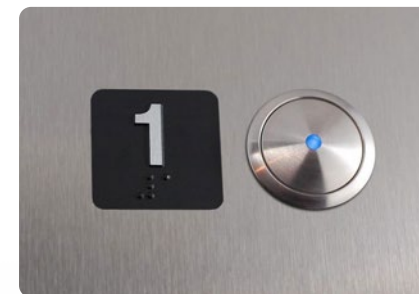

Square - Flush Mount

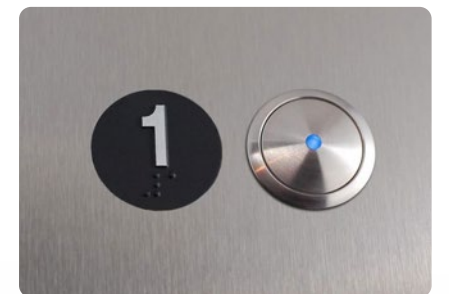

Round - Flush Mount

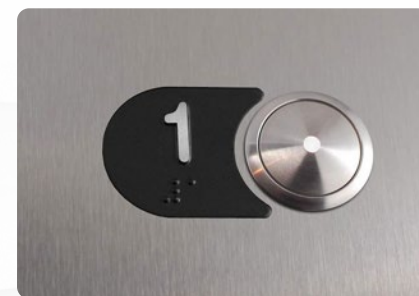

Julius - Flush Mount



California Fishtail

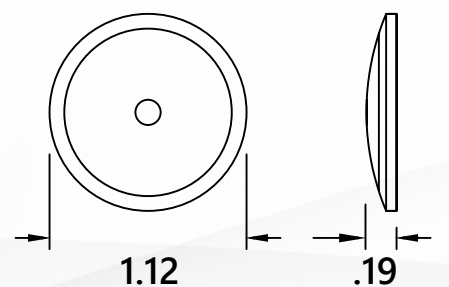

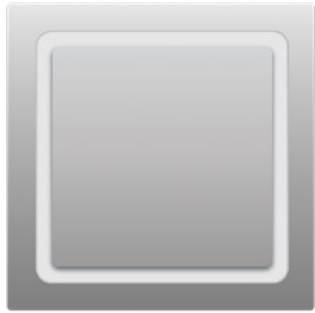

DUNE / DUNE CALIFORNIA

Built for durability and clarity, the Dune Series pushbuttons feature a vandal-resistant cast alloy design with a bright illuminated halo for enhanced visibility. Available in standard or California-compliant formats, both options can be paired with square braille tags—illuminated or non-illuminated—to meet your project’s accessibility needs. Rugged, modern, and reliable.

Illumination

Button Finish Available in #4 Stainless Steel

Tactile Pairings



Square - Surface Mount



Dune - White Illumination



Dune - Cast Tactile

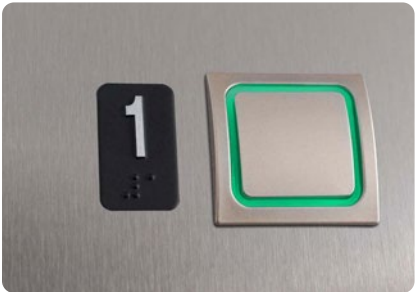

Slimline - Flush Mount



Square - Flush Mount

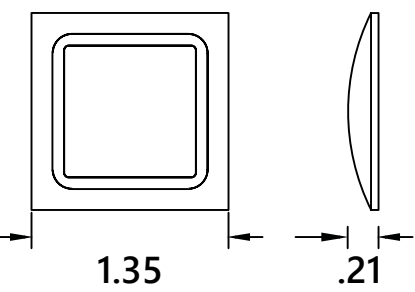

Square - Surface Mount



Dune - White Illumination



Dune - Cast Tactile



Slimline - Flush Mount



Square - Flush Mount

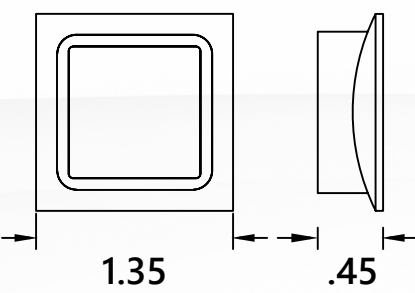

COLOSSUS

Designed to make a bold statement, the Colossus pushbutton features an oversized faceplate for maximum visibility and accessibility. Its durable build, tactile feedback, and illuminated halo make it ideal for high-traffic environments where functionality and impact matter most. A standout choice for both performance and presence.

Illumination

Button Finish Available in #4 Stainless Steel

Tactile Pairings



Square - Surface Mount



Slimline - Flush Mount



Square - Flush Mount



Square - Surface Mount



Slimline - Flush Mount



Square - Flush Mount

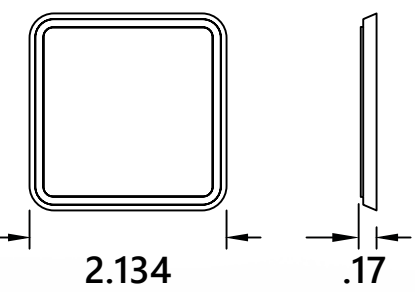



SHERMAN TOUCHLESS

Upgrade to a cleaner ride with MAD Elevator’s Sherman Touchless pushbutton—designed to reduce germ transmission on high-contact surfaces. Featuring dual technology, it responds to both touch-free sensor activation and standard manual press for code compliance. A perfect retrofit for DMG/MAD buttons, with crisp white LED illumination for visibility and modern appeal.

Illumination

Button Finish Available in #4 Stainless Steel & PVD Brass

Tactile Pairings

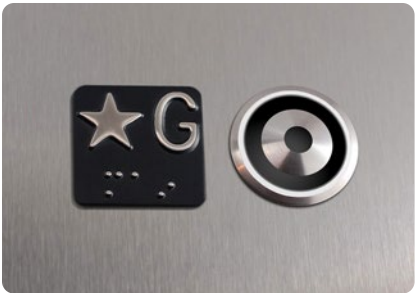

Square - Surface Mount



Julius Surround



Pin Mount



Caesar Non Illuminated



Caesar White Illuminated



Caesar Blue Illuminated



Slimline - Flush Mount



Square - Flush Mount

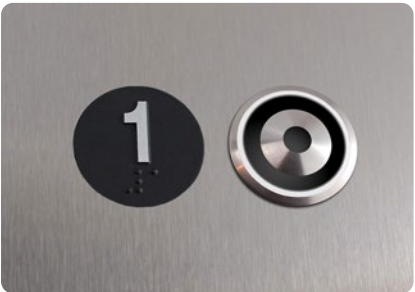

Round - Flush Mount



Julius - Flush Mount



California Fishtail

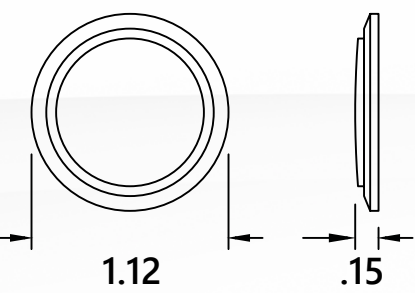

BAR BUTTON

The Bar Button is a vandal-resistant, extra-long pushbutton in brass or stainless steel, designed to match our Julius series with integrated ADA tactile.

Illumination

Button Finish Available in #4 Stainless Steel & PVD Brass

Tactile Pairings



Julius Surround - Illuminated



Julius Surround - Etched/Engraved



Julius Surround - Blank

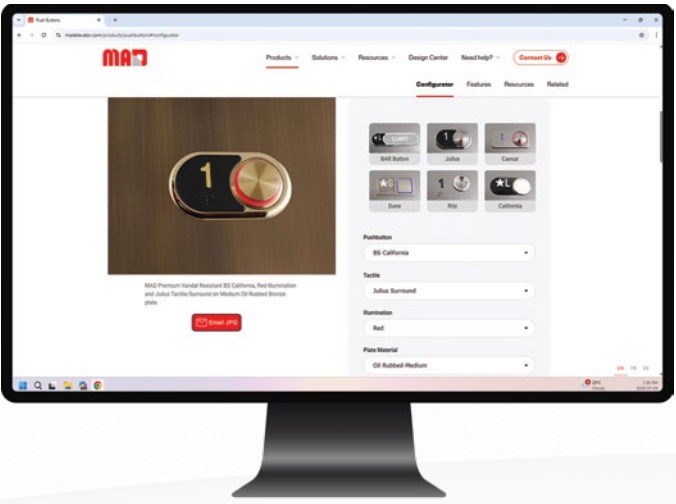
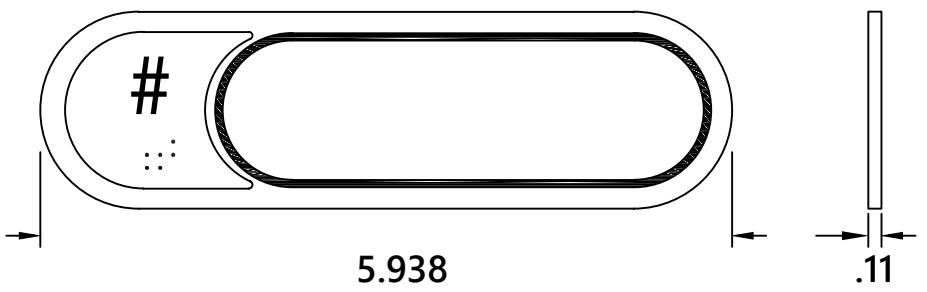

PUSHBUTTON CONFIGURATOR



Our Push Button Configurator makes it easy to customize finishes, illumination, braille tags, and more—all in one intuitive tool. Build your ideal look and functionality with just a few clicks.

See all of our available options by scanning the QR code.



HALL FIXTURES

Our Hall Fixtures offer reliable performance with flexible design options to suit any project. From Hall Stations and Lanterns to Destination Dispatch indicators, each fixture is built for durability, visibility, and seamless integration with your elevator system. Available in a range of finishes and mounting styles for new builds or retrofits.



SCAN HERE
To learn more!





HALL STATIONS

Our Hall Station collection is crafted with a quality that cannot be replicated. With numerous options we can match the look and feel of the building design and guarantee quality and compliance with the elevator and building code.

By offering a fully customizable experience we can provide different types of material such as stainless steel, bronze and glass with different mounting options.

Don't limit yourself, design the fixture your building deserves.

Buttons:

Available with MAD push buttons (Illuminations dependent on individual push button selection).

Fixture Type:

Gilda Classic, Corner and Curve Surface Mounts, Flush, Concealed or G2 Surface Mount.

Plate Finish:

Available in #4, #8 Stainless Steel, #4, #8 Bronze, or Oil Rubbed.



G2 Surface mount



Flush mount

Left Rendering Shown:

G2 Surface Mount Hall Station with Tri-Flame etching, fire service keyswitch, Vanishing Indicator and pushbutton.



HALL LANTERNS

Like our Hall Stations, we offer a fully customizable experience with our Hall Lanterns. We can provide different types of material such as stainless steel, bronze and glass along with various types of mounting options.

The Machined Silk Cast Acrylic of the Vision Series Lanterns is an elegant solution for the modern day lobby. The glass aesthetic enhances the architectural finishes for the lobby and hall, while the bright LED illumination is easy to see in all ambient light conditions.

Lens Illumination:
Red, Green, Blue, White

Arrow Type:
ADA, Round Lens, Vandal Resistant Arrows, Flag, or Vision Series (Acrylic or Glass). Digital TFT position indicators can also be included.

Fixture Type:
Gilda Classic, G2, Corner and Curve Surface Mounts, Flush, Concealed. Horizontal orientation available.

Plate Finish:
Available in #4, #8 Stainless Steel, #4, #8 Bronze, or Oil Rubbed.

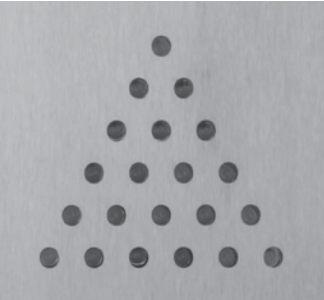

Vandal Resistant Arrow



Round Lens

Lantern Image Shown:
Flush Mount Hall Lantern with ADA illuminating arrows.



Flush Mount hall lantern with Raffaello Position Indicator



Vision Series hall lantern

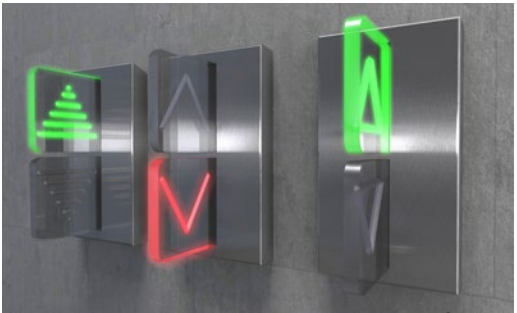

Flush Mount hall lantern with ADA Arrows and Raffaello Position Indicator

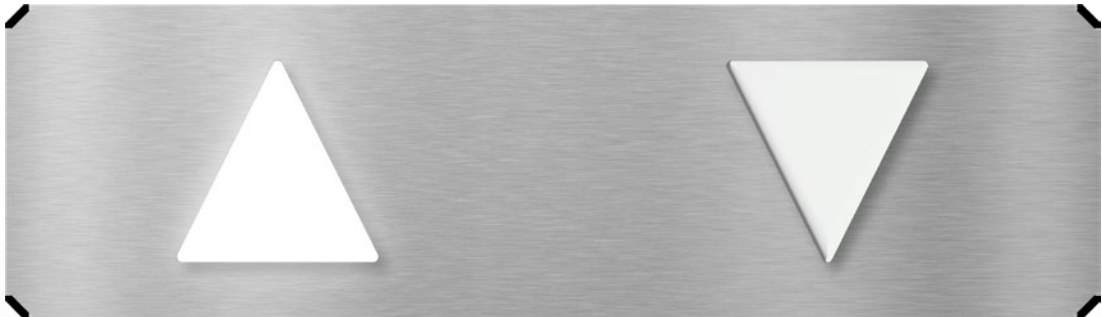

G2 Surface Mount hall lantern with ADA Arrows



DESTINATION DISPATCH



The Door-in-Door solution allows a single set of push buttons to be used for both fire and regular service. The inner door acts as the service cabinet providing access to both the button and service key-switches, while the outer door provides additional access to the fire service controls.



Upgrade the Destination Dispatch COP with a Touch-To-Go touchscreen. While in DD mode, the TTG screen can act as a next-destination indicator, a digital signage board, or used for 2-way video communication. In independent or fire service mode, the graphics will automatically change, allowing the passenger to select destination floors and eliminating need for 'hidden' mechanical pushbuttons.

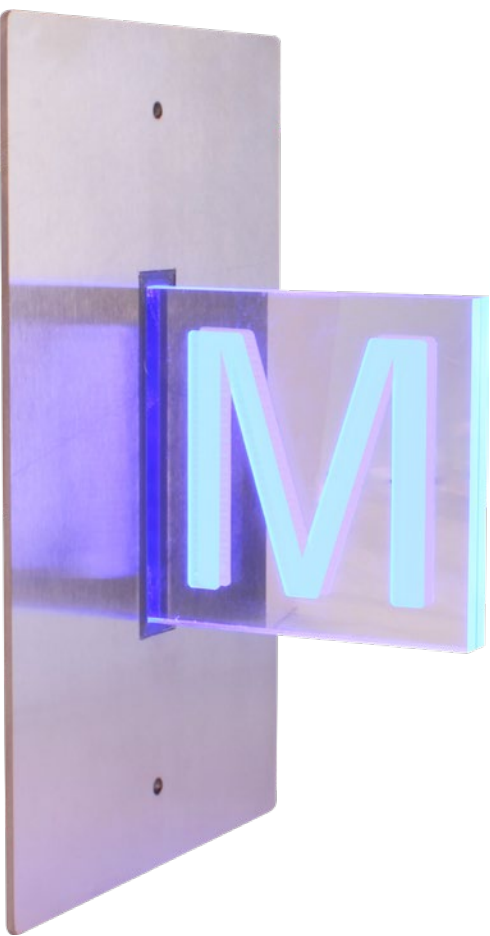

DESTINATION LANTERNS

MAD offers a variety of Destination Lanterns to meet your project requirements. Choose between our Value Series, Standard series or Concept (custom) design. From a plate design to illuminated flag, we can match the design of your building. Puck replacement and Ray Blade lanterns also available.

Lens Illumination:
Red, Green, Blue, White

Fixture Type:
Surface Mount, Flush Mount, Flag, Puck, or Ray Blade.

Plate Finish:
Available in #4, #8 Stainless Steel, #4, #8 Bronze, Brushed Black, Acrylic, or Glass.

Letter Type:
Standard or Custom Font in Acrylic or Glass.

Destination Dispatch Kiosks feature precision-crafted metal enclosures designed to complement touchscreen systems. Built for durability and modern appeal, our kiosks offer a sleek, high-end finish that seamlessly integrates into your building's design.



Flush mount

Surface mount



DISPLAYS

Our display lineup combines cutting-edge technology with elegant design to enhance passenger communication and experience. From sleek digital screens to customizable multimedia solutions, our Raffaello, Giotto, Matisse, Altus, and Touch-To-Go displays offer flexible formats for both standard and destination dispatch systems.



SCAN HERE
To learn more!



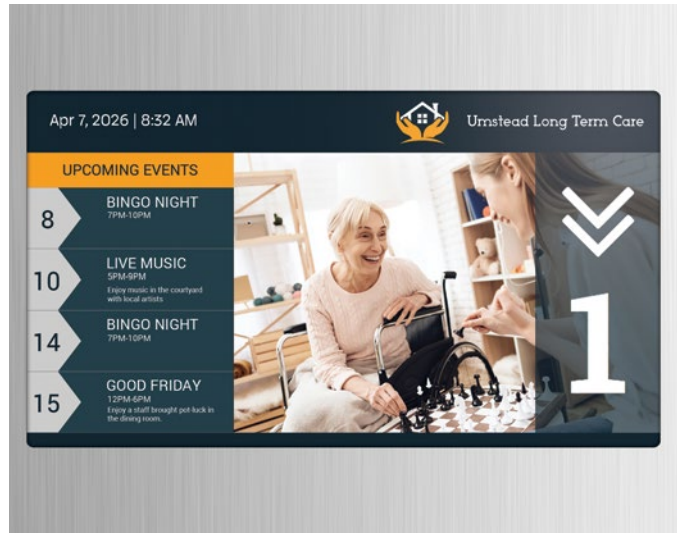

Matisse 10" Position Indicator



Giotto 7" Position Indicator



Raffaello 4.3" Position Indicator

POSITION INDICATORS

Matisse:

The premium option available in the TFT designer's series. Featuring a fully networkable unit with widgets, news, two-way video capabilities and live video streaming. All screens are designed on the cloud (networked). It is available in 7" up to 21".

Giotto:

The mid-range of the new TFT designer series with its multicolor graphic Position Indicator and integrated Voice Annunciator. Available in 4.3" & 7".

Raffaello:

The micro version of the three balances both cost and functionality. Perfect for integrating Position Indicators in your hall fixtures design or lobby panels. Available in 2.8" & 4.3".

- High resolution & fully customizable graphics.
- Integrated voice annunciator.
- Two-way video capable/VMS-ready (Matisse).
- Programmable audio and video messages.
- Self-administration with easy-to-use MosaicONE software.

Available Sizes:

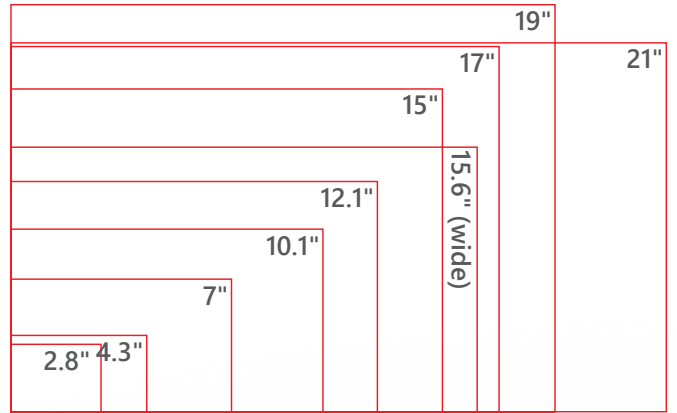

ALTUS

Combining the Mosaic Position Indicators, Matisse Digital Signage, and per floor messaging of Touch-To-Go, the Altus is large enough to take advantage of all the functionality in one. Available in 19", 28", 38" and 48". Can be positioned landscape or portrait.

- Remote admin & updatibility.
- Fully customizable.
- Time, weather, social media, news (RSS feeds), videos, photos, and HTML content.
- MosaicONE content integration.
- 'This Floor' and 'Next Stop' interactive messages.
- Live video input & two way video capable.
- Digital Signage.

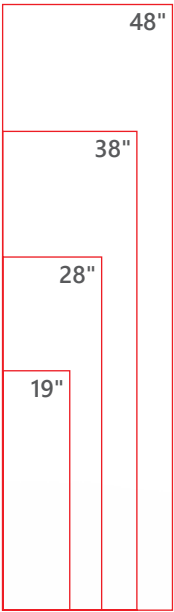

Left images Shown:

SS#4 COP, 48" Altus Position Indicator, Dune pushbutton and Surround Tactile.

TOUCH-TO-GO

Using vibrant, easy-to-read, color touchscreens linked to a custom control system, our elevator touchscreen systems create a distinctive experience that will have a high impact on the passenger and enhance the usability of the elevator.

- Interface with any elevator controller.
- Remote admin & updatability.
- 21" HD or 15" HD LED displays with a viewing angle of 178° Additional sizes available upon request.
- Security system integration.
- MosaicONE content integration.
- Vandal-resistant & code compliant.
- Operated with finger-touch or with a gloved/covered hand.
- 2-way video capable.
- Easy-to-clean surface with any glass approved solution.
- Seasonal themes included in touchscreen package.
- California Compliant keypad.

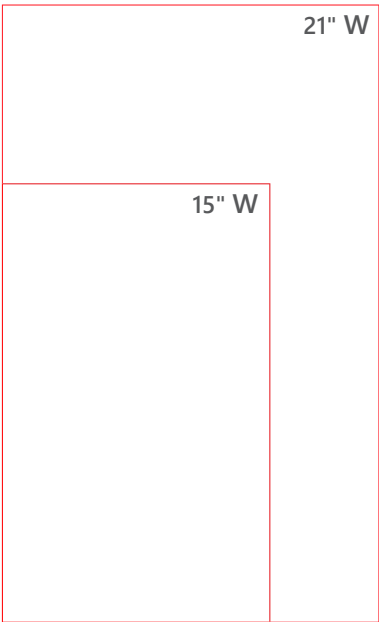

Left Rendering Shown:

SS#4 COP shown with 7" Giotto Position indicator, BS classic push button, Caesar surface mount non-illuminated tactile, ADA compliant key pad, 21" Touch-To-Go Touch Screen, 2010 service code with service cabinet.

Residential & Hotel Examples

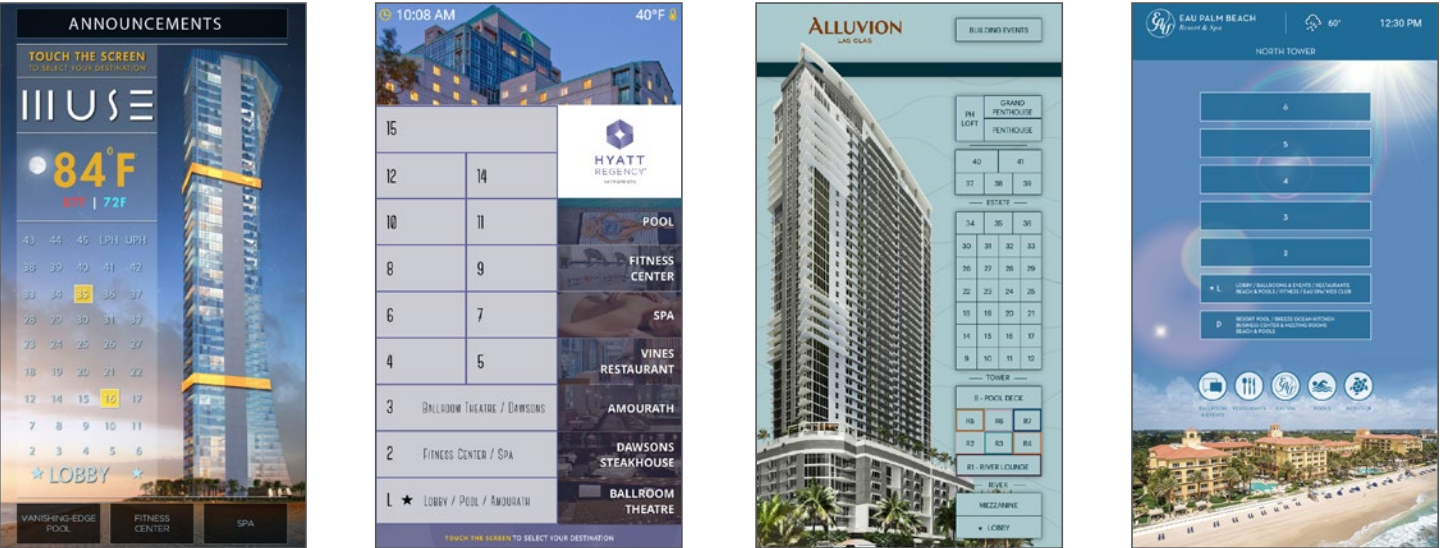

Hospital & Airport Examples

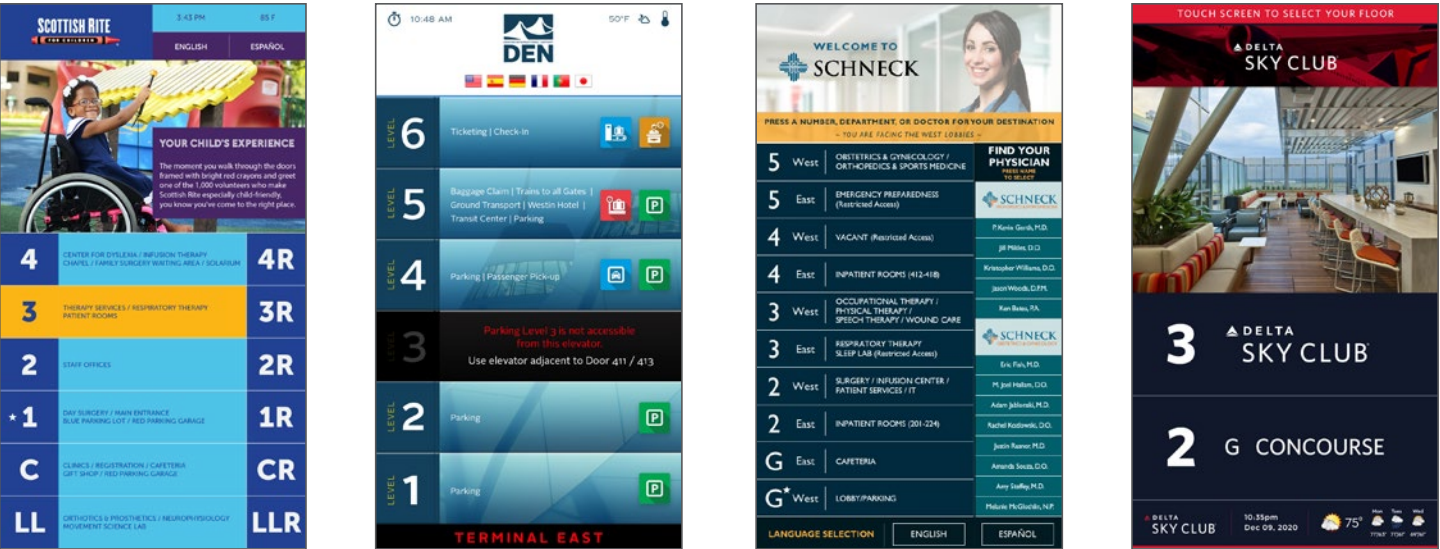

School & Commercial Examples





GERM-FREE SOLUTIONS

Our Touchless Solutions are designed to promote a cleaner, safer ride without compromising usability. From contact-free pushbuttons to enhanced accessibility features, our solutions help reduce germ transmission while meeting modern code requirements and passenger needs.



SCAN HERE
To learn more!





SHERMAN TOUCHLESS

The Sherman Touchless pushbutton is the perfect touch-free solution to the commonly touched elevator surface. Simply hold finger over button for sensor activation. Manual button function remains to meet code requirements.

- **Dual Technology:** Electromechanical contact (activated by push) and proximity sensor.
- Eliminates transferring germs through touched surfaces.
- Perfect retrofit product for DMG/MAD buttons.
- LED illumination available in white.

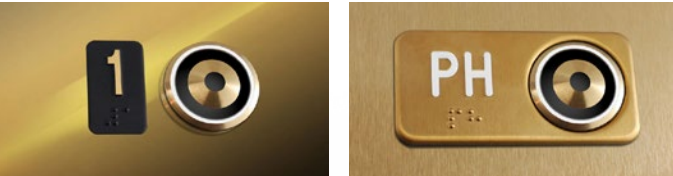

More Examples shown on Pg 22

Left Rendering Shown:
SS#4 Hall Station, Sherman Touchless pushbutton

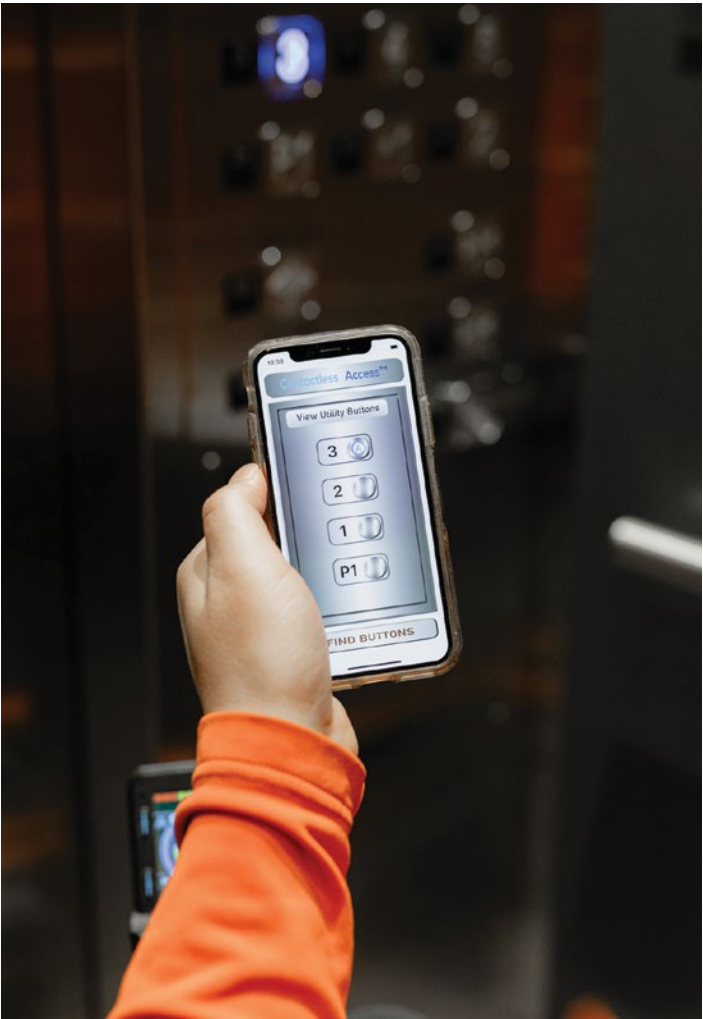

CONTACTLESS ACCESS™

Contactless Access™ is a seamless integration for elevator and building systems, enabling smartphone operation of elevator buttons and accessible doors. Designed to meet accessibility standards and minimize high-touch points, it delivers an efficient, hygienic, and future-ready solution that enhances user experience while supporting code compliance.

PATHS (Personal Access Token Holders)

PATHS is the companion app to Contactless Access™, enabling users to store and automatically run their most frequent routes—such as entering a building, opening accessible doors, and operating elevator controls—via Bluetooth connection to installed modules. Built with accessibility, privacy, and security in mind, PATHS collects no personal data, shares no saved routes, and uses tamper-proof safeguards for reliable, touch-free navigation.

- Free universal app.
(Requires ios 13+ /Android Lollipop 5.0+)
- Fully accessible touchless control.
- One-time cost - no recurring fees or subscriptions.
- Utilizes BLE technology, No WiFi or network access required - unhackable.
- No personal data tracked, stored or shared.
- Free, universal, simple to use app for elevators, doors, and mass transit.
- CSA B44.1/ASME A17.5
- FCC CAN ICES-003 (B)/NMB-003 (B)



Scan here to download our
Contactless Access™ App.





TOE-TO-GO

The Toe-To-Go (T2G) foot-activated elevator call button allows activation of hall & car station buttons by shoe, reducing the risk of transferring germs by creating a hands-free experience.

- ◉ Hands-Free activation.
- ◉ Robust durable design.
- ◉ Stainless Steel or PVD Brass finish.
- ◉ Easy retrofit for existing installation.
- ◉ Wire in parallel to existing buttons.
- ◉ Surface mount option for Hall Stations.
- ◉ Keypad option for COP.

NOTES:

BS COPPER

The BS Copper pushbutton, fitted with an untreated copper face, is a self-cleaning solution to the commonly touched elevator surface. Buttons can be paired with a large selection of braille tags to combine aesthetics and functionality.

- ◉ Naturally self-cleaning button.
- ◉ Vandal-proof
- ◉ Perfect retrofit product: Replace on the Pressel only, contact & wiring unchanged.
- ◉ LED Illumination in Red, Green, Blue & White.

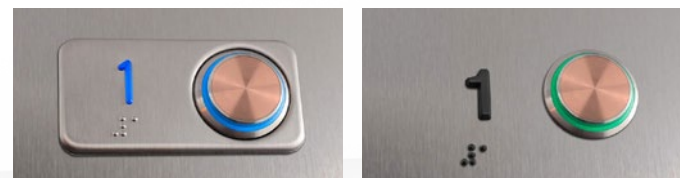

Left Rendering Shown:

SS#4 COP, 7" Giotto Position Indicator, Auto Dialer, Fire Service, BS Copper pushbutton, Julius Surround tactile.





6635 Ordan Dr,
Mississauga, ON
L5T 1K6
Canada

1 (866) 967-8500
madelevator.com
customerservice@madelevator.com

This publication is for general informational purposes only. Product design is subject to change without notice. Actual product colors, finishes and specifications may vary from graphical representations.

Copyright © MAD Elevator Inc.

Part of DMG Group of Companies

Ver 6.0